

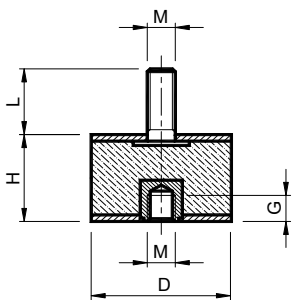

Cylindrical Bobbins: rubber / steel – Type:MF / Antivibrante Cilindrico: gomma / metallo – Tipo:MF



 Antivibration mounts made by rubber and steel parts  
**MATERIALS** metal components are zincplated  
 NR/SBR rubber compound  
**SHORE** 55° +/-5°  
**USE** male-female

 Antivibranti gomma-metallo  
**MATERIALI** parti metalliche sono zincate  
 Parti in gomma mescola NR/SBR  
**SHORE** 55° +/-5°  
**IMPIEGO** machio-femmina

Type Tipo	Cod. N°	D	H	L	G	M	Type Tipo	Cod. N°	D	H	L	G	M	Type Tipo	Cod. N°	D	H	L	G	M
MF2 6-7	AV001320	6	7	6	3	M3	1M1F2 25-25	AV001372	25	25	18	6	M6	1M1F2 50-40	AV001412	50	40	28	10	M10
MF2 8-8	AV001322	8	8	6	3	M3	MF2 25-28	AV001373	25	28	16	6	M6	1M1F2 50-45	AV001413	50	45	28	10	M10
MF2 10-7	AV001326	10	7	6	3	M3	1M1F2 25-30	AV001374	25	30	18	6	M6	1M1F2 50-50	AV001414	50	50	28	10	M10
1M1F2 10-10	AV001327	10	10	10	4	M4	1M1F2 30-15	AV001379	30	15	18	8	M8	1M1F2 60-30	AV001422	60	30	28	10	M10
1M1F2 10-15	AV001328	10	15	10	4	M4	1M1F2 30-20	AV001380	30	20	23	8	M8	1M1F2 60-30-M12	AV001423	60	30	37	12	M12
1M1F 13-10	AV001334	13	10	10	5	M5	1M1F 30-20-14	AV001381	30	20	14	8	M8	1M1F 60-35	AV001424	60	35	28	10	M10
MF2 15-8	AV001338	15	8	10	4	M4	1M1F2 30-25	AV001382	30	25	23	8	M8	MF2 60-40	AV001425	60	40	28	10	M10
MF2 15-8-6	AV001339	15	8	6	4	M4	1M1F2 30-30	AV001383	30	30	23	8	M8	1M1F2 60-40-M12	AV001426	60	40	28	12	M12
1M1F2 15-10	AV001340	15	10	10	4	M4	1M1F30-30-M6	AV001384	30	30	18	6	M6	1M1F 60-50	AV001427	60	50	35	10	M10
MF2 15-10 M5	AV001341	15	10	10	4	M5	1M1F2 30-40	AV001385	30	40	23	8	M8	1M1F 60-50-M12	AV001428	60	50	37	12	M12
1M1F2 15-15	AV001342	15	15	14	4	M4	MF2 40-15	AV001390	40	15	20	8	M8	1M1F2 65-35	AV001434	65	35	37	12	M12
MF2 15-15 M5	AV001343	15	15	8	6	M5	1M1F2 40-20	AV001391	40	20	23	8	M8	1M1F 65-50	AV001435	65	50	37	12	M12
MF2 15-20	AV001344	15	20	10	4	M4	MF2 40-20	AV001392	40	20	28	10	M10	1M1F2 70-45	AV001438	70	50	37	12	M12
MF2 15-30	AV001345	15	30	10	4	M4	1M1F2 40-25	AV001393	40	25	23	8	M8	1M1F2 75-25	AV001442	75	25	37	12	M12
1M1F 16-10	AV001349	16	10	12	5	M5	MF2 40-25-M10	AV001394	40	25	28	10	M10	1M1F2 75-40	AV001443	75	40	37	12	M12
1M1F 20-20	AV001354	20	10	16	6	M6	1M1F2 40-30	AV001395	40	30	23	8	M8	MF2 75-45	AV001444	75	45	37	12	M12
MF2 20-11	AV001355	20	11	18	6	M6	1M1F2 40-30-M10	AV001396	40	30	28	10	M10	1M1F2 75-50	AV001445	75	50	37	12	M12
1M1F2 20-15	AV001356	20	15	16	6	M6	1M1F 40-35	AV001397	40	35	23	8	M8	MF2 75-55	AV001446	75	55	37	12	M12
1M1F2 20-20	AV001357	20	20	16	6	M6	1M1F2 40-40	AV001398	40	40	23	8	M8	1M1F 100-30	AV001450	100	30	42	16	M16
1M1F2 20-25	AV001358	20	25	16	6	M6	1M1F2 40-40-M10	AV001399	40	40	28	10	M10	1M1F2 100-40	AV001451	100	40	42	16	M16
1M1F2 20-30	AV001359	20	30	16	6	M6	1M1F 40-45	AV001400	40	45	23	8	M8	1M1F2 100-50	AV001452	100	50	42	16	M16
1M1F2 25-15	AV001366	25	15	18	6	M6	1M1F2 50-20	AV001406	50	20	28	10	M10	1M1F2 100-55	AV001453	100	55	42	16	M16
1M1F 25-15-8	AV001367	25	15	8	6	M6	MF2 50-20-M8	AV001407	50	20	28	8	M8	1M1F2 100-60	AV001454	100	60	42	16	M16
1M1 25-15-M8	AV001368	25	15	18	6	M8	1M1F2 50-25	AV001408	50	25	28	10	M10	MF2 100-75	AV001455	100	75	41	16	M16
1M1F 25-18	AV001369	25	18	12	*	M5	1M1F2 50-30	AV001409	50	30	28	10	M10	MF2 150-50	AV001459	150	50	41	16	M16
1M1F2 25-20	AV001370	25	20	18	6	M6	MF2 50-30 M8	AV001410	50	30	23	8	M8	MF2 150-55	AV001460	150	55	41	16	M16
1M1 25-20-M8	AV001371	25	20	20	8	M8	MF2 50-35	AV001411	50	35	28	10	M10	MF2 150-75	AV001461	150	75	41	16	M16

Cylindrical Bobbins: rubber / steel – Type:MFT / Antivibrante Cilindrico gomma / metallo – Tipo:MFT

Type Tipo	Cod. N°	D	H	L	G	M
1M1F 20-25-10 SH45	AV001469	20	25	10	8	M6
1M1F 20-25-16 SH45	AV001470	20	25	16	6	M6
1M1F 25-15 SH45	AV001471	25	15	18	6	M6
1M1F 25-20 SH45	AV001472	25	20	18	6	M6
1M1F 30-30 SH45	AV001473	30	30	23	8	M8
1M1F 40-30 SH45	AV001474	40	30	23	8	M8

Type Tipo	Cod. N°	D	H	L	G	M
1M1F 40-30-M10 SH45	AV001475	40	30	28	10	M10
1M1F 50-30 SH45	AV001476	50	30	28	10	M10
1M1F 50-35 SH45	AV001477	50	35	28	10	M10
1M1F 50-50 SH45	AV001478	50	50	28	10	M10
1M1F 60-35 SH45	AV001479	60	35	30	10	M10
1M1F 75-50 SH45	AV001480	75	50	37	12	M12