



# ЗУБЧАТЫЕ ШКИВЫ ПОД РАСТОЧКУ ДЛЯ РЕМНЕЙ – ISO 5294

**H 150**

**Шаг 1/2" (12,7mm)**

Для ремней шириной 1 1/2 (38,1mm)

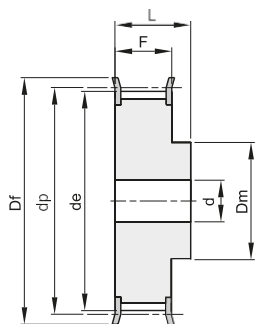

2 F

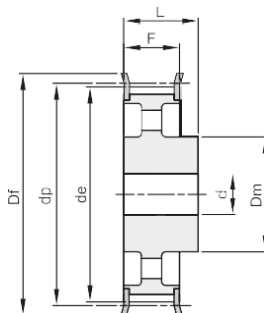

4 F

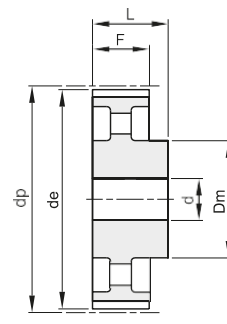

4

Материал: Сталь (St)  
Материал: Чугун (GG)

Описание	Артикул	Тип	Материал	Число зубьев	dp	de	Df	Dm	F	L	d	п° фланец	Вес, кг
14 H 150	15150014EMT	2F	St	14	56,59	55,22	63	40	46,0	58	18	309	0,81
15 H 150	15150015EMT	2F	St	15	60,64	59,27	66	45	46,0	58	18	310	0,97
16 H 150	15150016EMT	2F	St	16	64,68	63,31	71	45	46,0	58	18	311	1,11
17 H 150	15150017EMT	2F	St	17	68,72	67,35	75	45	46,0	58	18	312	1,25
18 H 150	15150018EMT	2F	St	18	72,77	71,39	79	55	46,0	58	18	313	1,48
19 H 150	15150019EMT	2F	St	19	76,81	75,44	83	60	46,0	58	18	314	1,68
20 H 150	15150020EMT	2F	St	20	80,85	79,48	87	62	46,0	58	18	315	1,88
21 H 150	15150021EMT	2F	St	21	84,89	83,52	91	65	46,0	58	18	316	2,08
22 H 150	15150022EMT	2F	St	22	88,94	87,56	93	68	46,0	58	18	317	2,30
23 H 150	15150023EMT	2F	St	23	92,98	91,61	97	72	46,0	58	18	318	2,54
24 H 150	15150024EMT	2F	St	24	97,03	95,65	103	72	46,0	58	18	320	2,75
25 H 150	15150025EMT	2F	St	25	101,06	99,69	106	72	46,0	58	18	321	2,97
26 H 150	15150026EMT	2F	St	26	105,11	103,73	111	80	46,0	58	18	322	3,29
27 H 150	15150027EMT	2F	St	27	109,15	107,78	115	80	46,0	58	18	323	3,52
28 H 150	15150028EMT	2F	St	28	113,19	111,82	119	80	46,0	58	18	325	3,78
29 H 150	15150029EMT	2F	St	29	117,23	115,86	123	80	46,0	58	18	326	4,03
30 H 150	15150030EMT	2F	St	30	121,29	119,90	127	80	46,0	58	18	327	4,29
32 H 150	15150032EMT	2F	St	32	129,36	127,99	135	80	46,0	58	18	328	4,86
33 H 150	15150033EMT	2F	St	33	133,40	132,03	140	80	46,0	58	18	330	5,15
34 H 150	15150034EMT	2F	St	34	137,45	136,07	143	80	46,0	58	18	331	5,46
35 H 150	15150035EMT	2F	St	35	141,49	140,12	148	80	46,0	58	18	333	5,78
36 H 150	15150036EMT	2F	St	36	145,53	144,16	152	80	46,0	58	18	334	6,09
38 H 150	15150038EMT	2F	St	38	153,62	152,24	158	80	46,0	58	18	335	6,74
40 H 150	15150040EMT	2F	St	40	161,70	160,33	168	80	46,0	58	18	338	7,46
44 H 150	15150044EMT	4F	GG	44	177,87	176,50	184	80	46,0	58	18	339	4,29
45 H 150	15150045EMT	4F	GG	45	181,91	180,54	192	80	46,0	58	18	340	4,44
48 H 150	15150048EMT	4F	GG	48	194,04	192,67	200	90	46,0	65	18	342	5,41
50 H 150	15150050EMT	4	GG	50	202,13	200,75		90	46,0	65	18		5,59
52 H 150	15150052EMT	4	GG	52	210,21	208,84		90	46,0	65	18		5,79
58 H 150	15150058EMT	4	GG	58	234,47	233,09		90	46,0	65	18		6,15
60 H 150	15150060EMT	4	GG	60	242,55	241,18		100	46,0	65	18		7,08
70 H 150	15150070EMT	4	GG	70	282,98	281,61		100	46,0	65	24		7,77
72 H 150	15150072EMT	4	GG	72	291,06	289,69		120	46,0	65	24		9,70
84 H 150	15150084EMT	4	GG	84	339,57	338,20		120	46,0	65	24		10,99
96 H 150	15150096EMT	4	GG	96	388,08	386,71		120	46,0	65	24		12,24
120 H 150	15150120EMT	4	GG	120	485,10	483,73		120	46,0	65	24		16,17