



ЗУБЧАТЫЕ ШКИВЫ ПОД РАСТОЧКУ ДЛЯ РЕМНЕЙ – ISO 5294

H 200

Шаг 1/2" (12,7mm)

Для ремней шириной 2" (50,8mm)

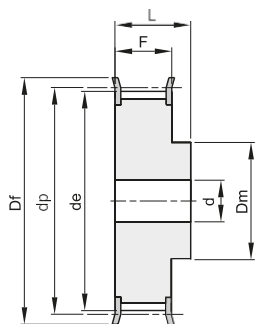

2 F

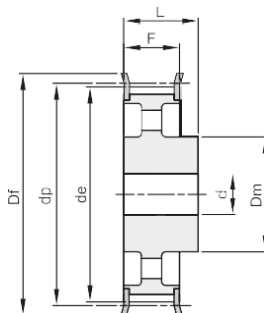

4 F

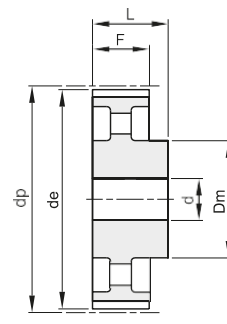

4

Материал: Сталь (St)
Материал: Чугун (GG)

| Описание | Артикул | Тип | Материал | Число зубьев | dp | de | Df | Dm | F | L | d | н° фланец | Вес, кг |
|-----------|-------------|-----|----------|--------------|--------|--------|-----|-----|------|----|----|-----------|---------|
| 14 H 200 | 15200014EMT | 2F | St | 14 | 56,59 | 55,22 | 63 | 40 | 58,7 | 70 | 18 | 309 | 1,10 |
| 15 H 200 | 15200015EMT | 2F | St | 15 | 60,64 | 59,27 | 66 | 45 | 58,7 | 70 | 18 | 310 | 1,33 |
| 16 H 200 | 15200016EMT | 2F | St | 16 | 64,68 | 63,31 | 71 | 45 | 58,7 | 70 | 18 | 311 | 1,54 |
| 17 H 200 | 15200017EMT | 2F | St | 17 | 68,72 | 67,35 | 75 | 45 | 58,7 | 70 | 18 | 312 | 1,69 |
| 18 H 200 | 15200018EMT | 2F | St | 18 | 72,77 | 71,39 | 79 | 55 | 58,7 | 70 | 18 | 313 | 1,95 |
| 19 H 200 | 15200019EMT | 2F | St | 19 | 76,81 | 75,44 | 83 | 60 | 58,7 | 70 | 18 | 314 | 2,20 |
| 20 H 200 | 15200020EMT | 2F | St | 20 | 80,85 | 79,48 | 87 | 62 | 58,7 | 70 | 18 | 315 | 2,44 |
| 21 H 200 | 15200021EMT | 2F | St | 21 | 84,89 | 83,52 | 91 | 65 | 58,7 | 70 | 18 | 316 | 2,70 |
| 22 H 200 | 15200022EMT | 2F | St | 22 | 88,94 | 87,56 | 93 | 68 | 58,7 | 70 | 18 | 317 | 2,97 |
| 23 H 200 | 15200023EMT | 2F | St | 23 | 92,98 | 91,61 | 97 | 72 | 58,7 | 70 | 18 | 318 | 3,25 |
| 24 H 200 | 15200024EMT | 2F | St | 24 | 97,03 | 95,65 | 103 | 72 | 58,7 | 70 | 18 | 320 | 3,56 |
| 25 H 200 | 15200025EMT | 2F | St | 25 | 101,06 | 99,69 | 106 | 72 | 58,7 | 70 | 18 | 321 | 3,81 |
| 26 H 200 | 15200026EMT | 2F | St | 26 | 105,11 | 103,73 | 111 | 80 | 58,7 | 70 | 18 | 322 | 4,18 |
| 27 H 200 | 15200027EMT | 2F | St | 27 | 109,15 | 107,78 | 115 | 80 | 58,7 | 70 | 18 | 323 | 4,49 |
| 28 H 200 | 15200028EMT | 2F | St | 28 | 113,19 | 111,82 | 119 | 80 | 58,7 | 70 | 18 | 325 | 4,81 |
| 29 H 200 | 15200029EMT | 2F | St | 29 | 117,23 | 115,86 | 123 | 80 | 58,7 | 70 | 18 | 326 | 5,14 |
| 30 H 200 | 15200030EMT | 2F | St | 30 | 121,29 | 119,90 | 127 | 80 | 58,7 | 70 | 18 | 327 | 5,47 |
| 32 H 200 | 15200032EMT | 2F | St | 32 | 129,36 | 127,99 | 135 | 80 | 58,7 | 70 | 18 | 328 | 6,17 |
| 33 H 200 | 15200033EMT | 2F | St | 33 | 133,40 | 132,03 | 140 | 80 | 58,7 | 70 | 18 | 330 | 6,56 |
| 34 H 200 | 15200034EMT | 2F | St | 34 | 137,45 | 136,07 | 143 | 80 | 58,7 | 70 | 18 | 331 | 6,94 |
| 35 H 200 | 15200035EMT | 2F | St | 35 | 141,49 | 140,12 | 148 | 80 | 58,7 | 70 | 18 | 333 | 7,34 |
| 36 H 200 | 15200036EMT | 2F | St | 36 | 145,53 | 144,16 | 152 | 80 | 58,7 | 70 | 18 | 334 | 7,75 |
| 38 H 200 | 15200038EMT | 2F | St | 38 | 153,62 | 152,24 | 158 | 80 | 58,7 | 70 | 18 | 335 | 8,62 |
| 40 H 200 | 15200040EMT | 2F | St | 40 | 161,70 | 160,33 | 168 | 80 | 58,7 | 70 | 18 | 338 | 9,50 |
| 44 H 200 | 15200044EMT | 4F | GG | 44 | 177,87 | 176,50 | 184 | 80 | 58,7 | 70 | 18 | 339 | 5,14 |
| 45 H 200 | 15200045EMT | 4F | GG | 45 | 181,91 | 180,54 | 192 | 80 | 58,7 | 70 | 18 | 340 | 5,38 |
| 48 H 200 | 15200048EMT | 4F | GG | 48 | 194,04 | 192,67 | 200 | 90 | 58,7 | 75 | 24 | 342 | 6,29 |
| 50 H 200 | 15200050EMT | 4 | GG | 50 | 202,13 | 200,75 | | 90 | 58,7 | 75 | 24 | | 6,68 |
| 52 H 200 | 15200052EMT | 4 | GG | 52 | 210,21 | 208,84 | | 90 | 58,7 | 75 | 24 | | 6,81 |
| 58 H 200 | 15200058EMT | 4 | GG | 58 | 234,47 | 233,09 | | 90 | 58,7 | 75 | 24 | | 7,26 |
| 60 H 200 | 15200060EMT | 4 | GG | 60 | 242,55 | 241,18 | | 100 | 58,7 | 75 | 24 | | 8,25 |
| 70 H 200 | 15200070EMT | 4 | GG | 70 | 282,98 | 281,61 | | 100 | 58,7 | 75 | 28 | | 9,20 |
| 72 H 200 | 15200072EMT | 4 | GG | 72 | 291,06 | 289,69 | | 120 | 58,7 | 75 | 28 | | 11,09 |
| 84 H 200 | 15200084EMT | 4 | GG | 84 | 339,57 | 338,20 | | 120 | 58,7 | 75 | 28 | | 12,63 |
| 96 H 200 | 15200096EMT | 4 | GG | 96 | 388,08 | 386,71 | | 120 | 58,7 | 75 | 28 | | 14,51 |
| 120 H 200 | 15200120EMT | 4 | GG | 120 | 485,10 | 483,73 | | 120 | 58,7 | 75 | 28 | | 19,15 |